

Please Note

Please follow all instructions carefully. Failure to do so could invalidate your guarantee. As with the installation of any water bearing product, you must make sure that any laws prevalent to your area are followed. Such laws may include Local & National Water Supply Authority Regulations or Byelaws and Building and Plumbing Regulations. We recommend that a qualified registered plumber is used to install your product. Please ensure that when fitted, the product is easily accessed for service and maintenance requirements. Armera cannot be held liable for costs associated with accessing the product after it is fitted.

Contact Us

Should you need any assistance, please e-mail us at info@armera.co.uk or call 01225 251 204

Caring for your Armera product

We recommend only cleaning your product with a soft damp cloth. Please do not use any other cleaning products as they may damage the high quality finish of this product.

Guarantee

This Armera product is guaranteed against manufacturing defects. The cover period is from date of supply to the Armera customer and will last for 2 years for parts and labour. The parts guarantee can be extended to 15 years by registering your guarantee. To register your guarantee and review all guarantee conditions, please go to www.armera.co.uk



ARMERA®

Installation Instructions

BW.232 Bath filler waste with click clack plug



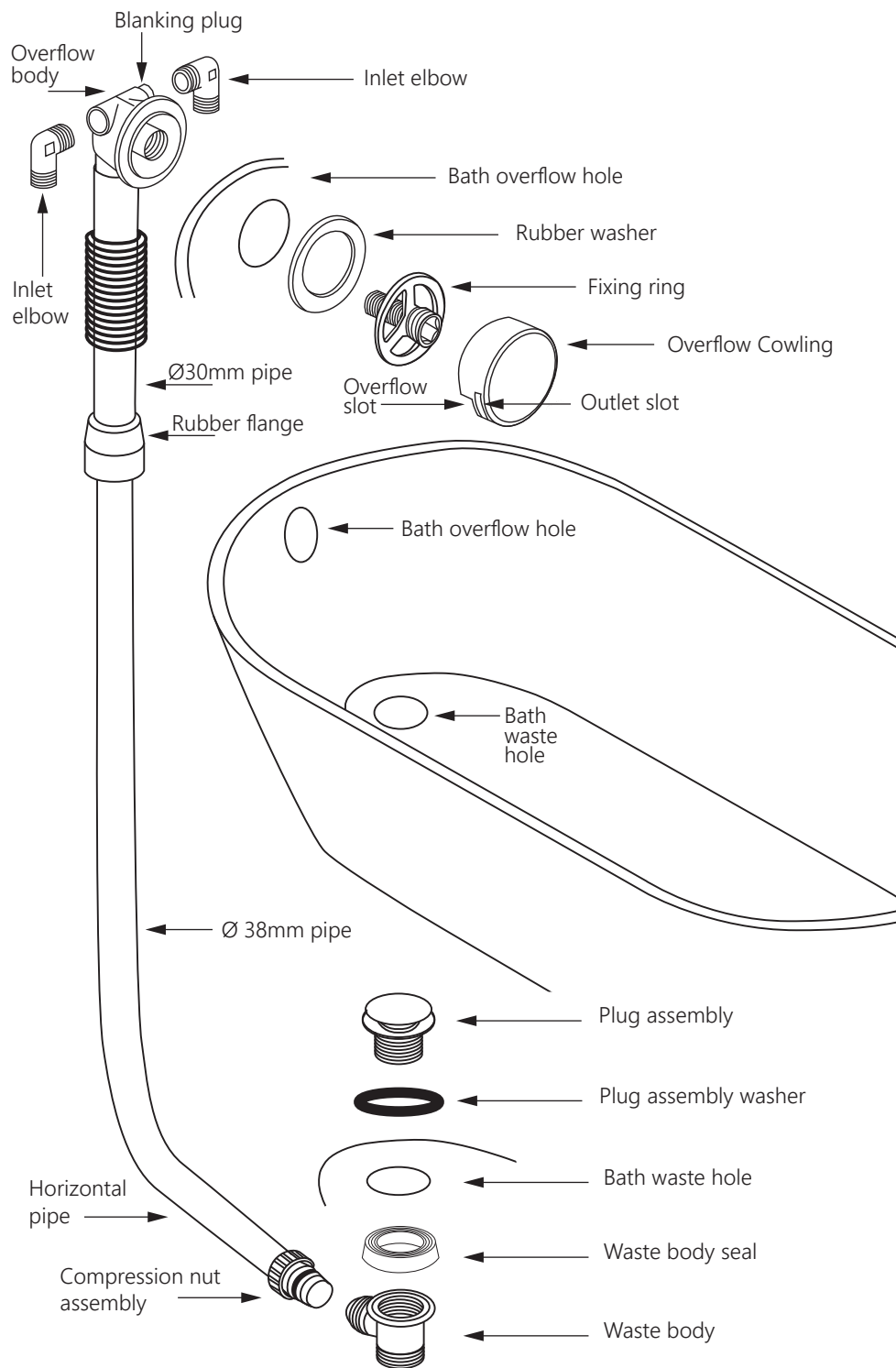

Installation

1. If using blended water supply to the filler waste, leave the blanking plug in position in one inlet. Using PTFE tape, fit an inlet elbow to the other inlet.
2. If using separate hot and cold supplies, remove the blanking plug from the overflow body and using PTFE tape, fit both inlet elbows into the overflow body.
3. Using the small allen key provided, loosen the grub screw at the bottom of the overflow cowling and pull the overflow cowling away from the fixing ring.
4. Unscrew the fixing ring from the overflow body.
5. Position the overflow body at the back of the overflow hole on the bath and secure in position by attaching the rubber washer and fixing ring at the front of the bath. Tighten the fixing ring using the large allen key provided.
6. Push the overflow cowling onto the fixing ring (ensuring the overflow slot and outlet slot face downwards). Secure in position by tightening the grub screw using the small allen key provided.
7. Connect the water supply to the inlet elbow(s).
8. Join the Ø30mm pipe to the Ø38mm pipe using the rubber flange. The length of the upright pipe can now be altered by sliding the Ø30mm pipe up or down inside the Ø38mm pipe. If necessary, either of the pipes can be cut down to further reduce the length.
9. Separate the plug assembly and plug assembly washer from the waste body.
10. Cut the horizontal pipe to desired length so that the waste body sits directly under the waste hole in the bath when it is attached to the pipe.
11. Join the horizontal pipe to the waste body using the compression nut assembly.
12. Screw the plug assembly into the waste body. Ensure that the plug assembly washer sits inside the bath and that the waste body seal sits below the bath (attached to the waste body)
13. Check for leaks.

Operation

The click clack waste allows the plug to be opened and closed by a simple push action with the fingertips:

